

All Breed Judged Trail Ride



The Walking Horse Association of Michigan is proud to invite you to participate in the fourteenth annual All Breed Judged Pleasure Ride to be held at Silver Creek Horseman's park in Allegan County, Michigan on **May 22, 2010**. A marked trail ride of approximately 7 miles will contain at least ten obstacles for you to navigate testing your horsemanship skills, trail safety knowledge as well as the attitude and willingness of your horse. Points will be awarded at each obstacle and the people with the highest point totals will receive cash prizes. Lunch will be served at the completion of the ride. Camping is available on a first come, first served basis. A portion of the proceeds will be donated to the park for maintenance of equine campsites and trails.

Rain or shine event!

When: **May 22nd, 2010**. Registration 8:00 a.m. Judging 9:00 a.m. – 2:00 p.m.
All score cards must be turned in by 2:30. Awards ceremony will be at 3:00.

Where: Silver Creek Horseman's Camp, 3900 - 134th Street, Hamilton MI 49419 (map on reverse)
Cost: \$30 per person. (**No Refunds**) * **Free T-shirt if registered before May 1st**.

Prizes: Overall high score \$100, Second place overall \$50, Division high score \$50, Ribbons for 1st - 5th place & Certificate of participation (Overall 1st and 2nd can not also win division)

Divisions: Youth Rider (12 & under), Youth Rider (13-17), Senior Rider (50 & older), Young Horse (5 & under), Mature horse (6 - 10), Senior Horse (11 & over), TWH (all ages)

Questions: Joy @ 269-751-8093 (smittyd@wmol.com) / ReBecca (justbigtime@yahoo.com)

Name: _____

Divisions: (chose ONLY one)

Address: _____

____ Youth Rider (12 & under)

City, St. Zip _____

____ Youth Rider (13-17)

Phone: _____

____ Senior Rider (50 +)

Email Address: _____

____ Young Horse (5 & under)

*T-Shirt Size ____X-Large ____Large ____Medium ____ Small

____ Mature Horse (6 – 10)

____ Senior Horse (11 & over)

____ TWH (all ages)

Make checks payable to: WHAM Region 2

Please mail registration along with payment to:

ReBecca Luthringer, 2080 S. M-139, Benton Harbor, MI 49022

**Youth riders 14 and under must be accompanied by an adult and must wear protective head gear. All riders must use proper riding equipment. Helmets are strongly encouraged. Bareback riding is not recommended.

Location: Silver Creek Park is located just east of M-40 at the corner of 134th Avenue and 38th Street in northeast Heath Township. There are two entrances to the park, one on 134th Avenue and one on 38th Street, and both are indicated with signs. If you have a large rig, it is advised you use the 38th street entrance.

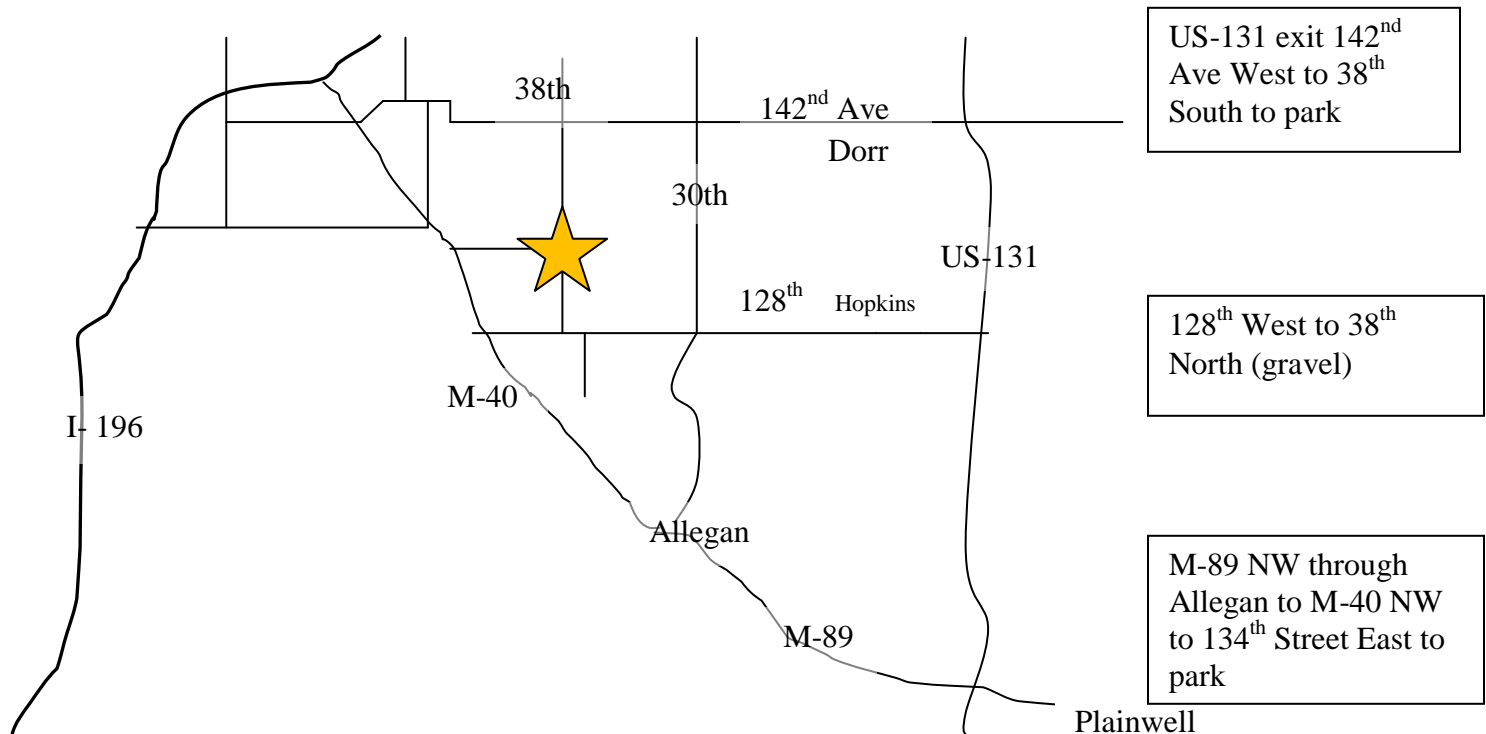

What is a judged trail ride? A judged trail ride consists of several man-made and natural obstacles on a trail where you and your horse will be judged on how well you complete the task. You may also be tested on your general trail safety knowledge as part of an obstacle.

What does the Entry fee include? The entry fee of \$30 covers one rider's entry fee for the ride, making him or her eligible for the end of day prizes which include cash and ribbons. We also provide lunch for that rider, and all entrants who pre-register before May 1st will receive a free T-shirt the day of the ride. Meal tickets for non-riders may be purchased for \$5.00

What time does it start? Registration will begin at 8:00 a.m. All pre-registered riders will pick up their scorecards, T shirts and meal tickets. Those who have not yet registered may do so and collect their scorecard and meal tickets, but will not receive a T shirt. We will begin sending riders out at approximately 9 a.m. We will stagger riders to help avoid back-ups at any of the obstacles. Riders may start any time after 9:00 a.m., but judging will END at 2:00 p.m. sharp, so be sure to leave yourself plenty of time to complete the ride. Score cards must be turned in by 2:30 p.m.!

What are the prizes? Cash awards will go to top finishers. The first and second place finishers overall (highest total score, regardless of category) will win \$100 and \$50 respectively. These top winners MAY NOT win the category prizes. The winner of each category will receive \$50. Ribbons will be awarded through 5th place in each category.

Can I camp? Yes, camping is available at Silver Creek. However, there are no hook-ups and the camping fee must be paid to the park. Spots fill early so you might want to make reservations. You can make your reservations on line by going to www.allegancounty.org or call (269) 673-0378. Camping fees are \$12/night +\$3/horse. If you don't camp, arrive early. *Day Passes are \$5/day/horse. Season Passes are still \$25/yr and covers all the horses in your trailer.*

What is the purpose of the ride? In addition to having the ride so you may come out and test your trail skills and just have a fun day, the goal of the ride is to raise money for the Silver Creek County Park for trail and campsite maintenance. If we do not help support parks like these, we may lose them forever. Each year we give a portion of the proceeds to Silver Creek with hope that we may continue to have the opportunity to enjoy this wonderful park for many years to come!